

Charles Morris,
Chair
Town of Linden

Diane Wheatley,
Vice-Chair
Cumberland County

Jami McLaughlin,
Town of Spring Lake
Harvey Cain, Jr.,
Town of Stedman

Donovan McLaurin
Wade, Falcon & Godwin



Thomas J. Lloyd,
Director

Cecil P. Combs,
Deputy Director

Vikki Andrews,
Carl Manning,
Cumberland County

Stan Crumpler,
Town of Eastover

Patricia Hall,
Town of Hope Mills

COUNTY of CUMBERLAND

Planning & Inspections Department

July 26, 2017

MEMORANDUM

TO: Cumberland County Joint Planning Board
Cumberland County Board of Education
Embarq
Fayetteville Public Works Commission

FROM: Jeff Barnhill, Planner I
Land Use Codes Section

SUBJECT: Monthly Report for July 2017
Subdivision & Site Development Plans

The following list of projects is submitted for your information. Please find attached a copy of the respective vicinity maps indicated by the case number and project name.

1. CASE NO: 06-128
NAME OF DEVELOPMENT: Stoney Point Elementary School
TYPE OF REVIEW: Site Plan Review
LOCATION: 7403 & 7411 Rockfish Road
ZONING: RR Rural Residential District
NUMBER OF UNITS: 1
TOTAL ACREAGE: 109.48 +/-
JURISDICTION: Cumberland County
STAFF APPROVAL DATE: July 5, 2017
OWNER/DEVELOPER: Cumberland County Board of Education
2. CASE NO: 16-024
NAME OF DEVELOPMENT: Salon Fredrique
TYPE OF REVIEW: C1(P) Site Plan Review
LOCATION: 3840 Cumberland Road
ZONING: C1(P) Planned Commercial District
NUMBER OF UNITS: 1
TOTAL ACREAGE: .66 +/-
JURISDICTION: Cumberland County
STAFF APPROVAL DATE: July 6, 2017
OWNER/DEVELOPER: Fredrique Francoi's

3. CASE NO: 17-086
NAME OF DEVELOPMENT: Gallberry Farm Elementary School
TYPE OF REVIEW: A1 Site Plan Review
LOCATION: 3019 Byerly Drive
ZONING: A1 Agricultural District
NUMBER OF UNITS: 1
TOTAL ACREAGE: 25.00 +/-
JURISDICTION: Cumberland County
STAFF APPROVAL DATE: July 6, 2017
OWNER/DEVELOPER: Spell Construction

4. CASE NO: 17-029
NAME OF DEVELOPMENT: Winchester Subdivision
TYPE OF REVIEW: Zero Lot Line Subdivision Review
LOCATION: 2157 School Road
ZONING: A1 Agricultural District
NUMBER OF LOTS: 6
TOTAL ACREAGE: 6.12 +/-
JURISDICTION: Cumberland County
STAFF APPROVAL DATE: July 10, 2017
OWNER/DEVELOPER: M.A.P.S. Surveying

5. CASE NO: 17-055
NAME OF DEVELOPMENT: ABC Storage
TYPE OF REVIEW: C(P) Site Plan & Subdivision Review
LOCATION: 3768 Dunn Road
ZONING: C(P) Planned Commercial (CCOD Commercial Core Overlay)
NUMBER OF LOTS: 3
TOTAL ACREAGE: 4.18 +/-
JURISDICTION: Eastover
STAFF APPROVAL DATE: May 10, 2017
EASTOVER TOWN COUNCIL: July 11, 2017
OWNER/DEVELOPER: George Rose

6. CASE NO: 17-087
NAME OF DEVELOPMENT: Mitchell Gilmore Property
TYPE OF REVIEW: Group Development Review
LOCATION: 4938 S. Main Street
ZONING: R6A Residential District
NUMBER OF LOTS: 2
TOTAL ACREAGE: 3.30 +/-
JURISDICTION: Cumberland County
STAFF APPROVAL DATE: July 12, 2017
OWNER/DEVELOPER: Mitchell Gilmore

7. CASE NO: 17-088
NAME OF DEVELOPMENT: Gary Robinson Property
TYPE OF REVIEW: Subdivision Review
LOCATION: 5214 NC HWY 242
ZONING: A1 Agricultural District
NUMBER OF LOTS: 2
TOTAL ACREAGE: 7.42 +/-
JURISDICTION: Cumberland County
STAFF APPROVAL DATE: July 13, 2017
OWNER/DEVELOPER: Gary Robinson

8. CASE NO: 17-093
NAME OF DEVELOPMENT: David Nail Jr. Property
TYPE OF REVIEW: Group Development Review
LOCATION: 1116 John McMillan Road
ZONING: A1 Agricultural District
NUMBER OF UNITS: 2
TOTAL ACREAGE: 23.98 +/-
JURISDICTION: Cumberland County
STAFF APPROVAL DATE: July 20, 2017
OWNER/DEVELOPER: David Nail Jr.

9. CASE NO: 17-089
NAME OF DEVELOPMENT: Leisa Williams Property
TYPE OF REVIEW: Group Development Review
LOCATION: 5113 Pondwood Drive
ZONING: A1 Agricultural District
NUMBER OF UNITS: 2
TOTAL ACREAGE: 3.04 +/-
JURISDICTION: Cumberland County
STAFF APPROVAL DATE: July 20, 2017
OWNER/DEVELOPER: Leisa Williams

10. CASE NO: 17-090
NAME OF DEVELOPMENT: Jessie Britt Sr. Property
TYPE OF REVIEW: Zero Lot Line Subdivision Review
LOCATION: 6873 Roslin Farm Road
ZONING: A1 Agricultural District
NUMBER OF UNITS: 2
TOTAL ACREAGE: 4.16 +/-
JURISDICTION: Cumberland County
STAFF APPROVAL DATE: July 21, 2017
OWNER/DEVELOPER: Jessie Britt

**STONEY POINT ELEMENTARY ADDITION PROPERTY
RR - SITE PLAN REVIEW
CASE NO. 06 - 128**

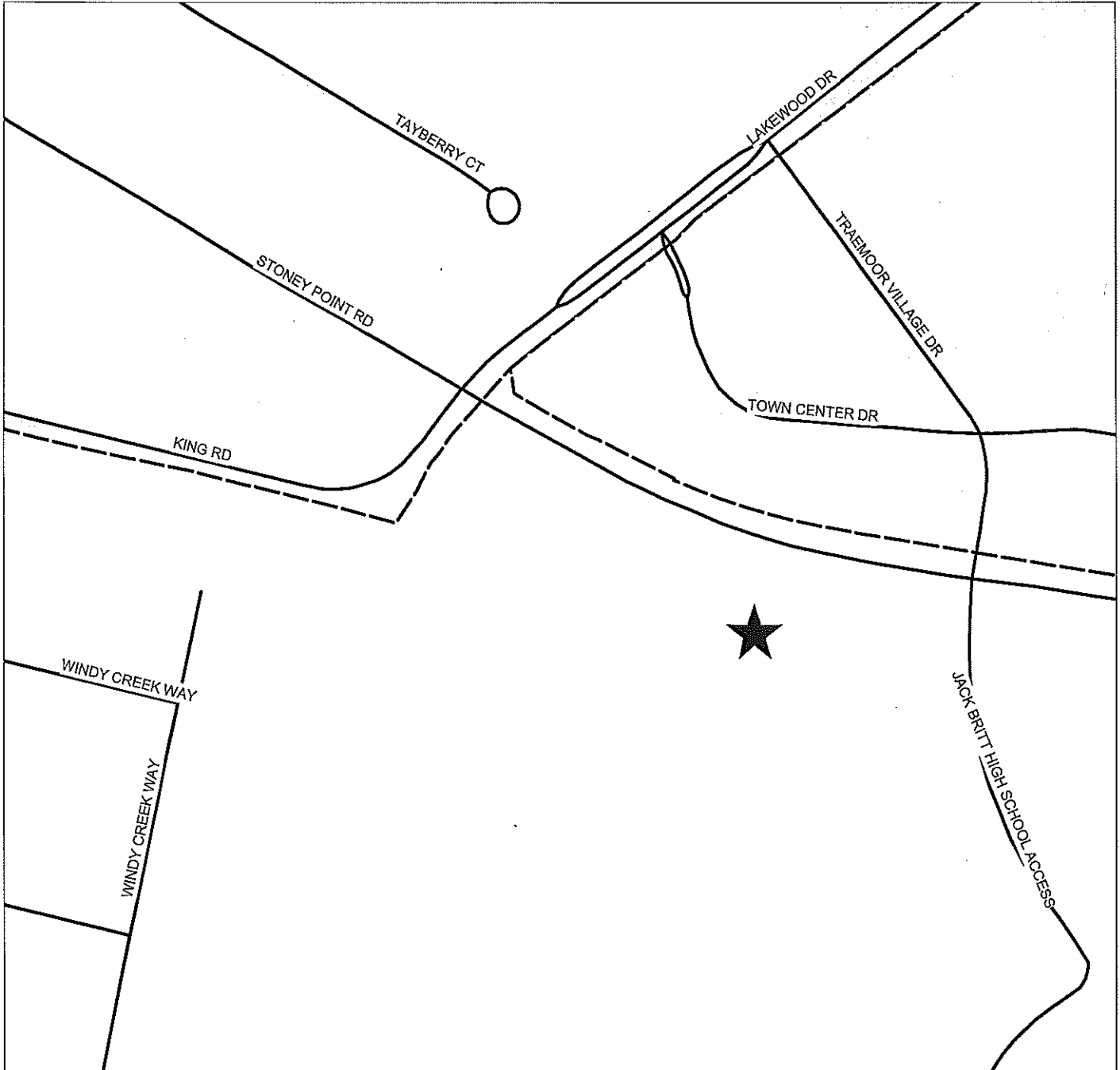

PIN(S): 9494-66-3716-
red by GJB - CCJPB
JUNE 3, 2010

Map not to scale



**MOTOMECH CYCLES & ACCESSORIES PROPERTY
C1(P) SITE PLAN REVIEW
CASE NO. 16-024**



PIN(S): -0415-79-4784-
Created by GJB - EMB
FEBRUARY 2, 2016

Map not to scale



GALLBERRY FARM ELEMENTARY SCHOOL SITE PLAN REVIEW CASE NO. 17-086

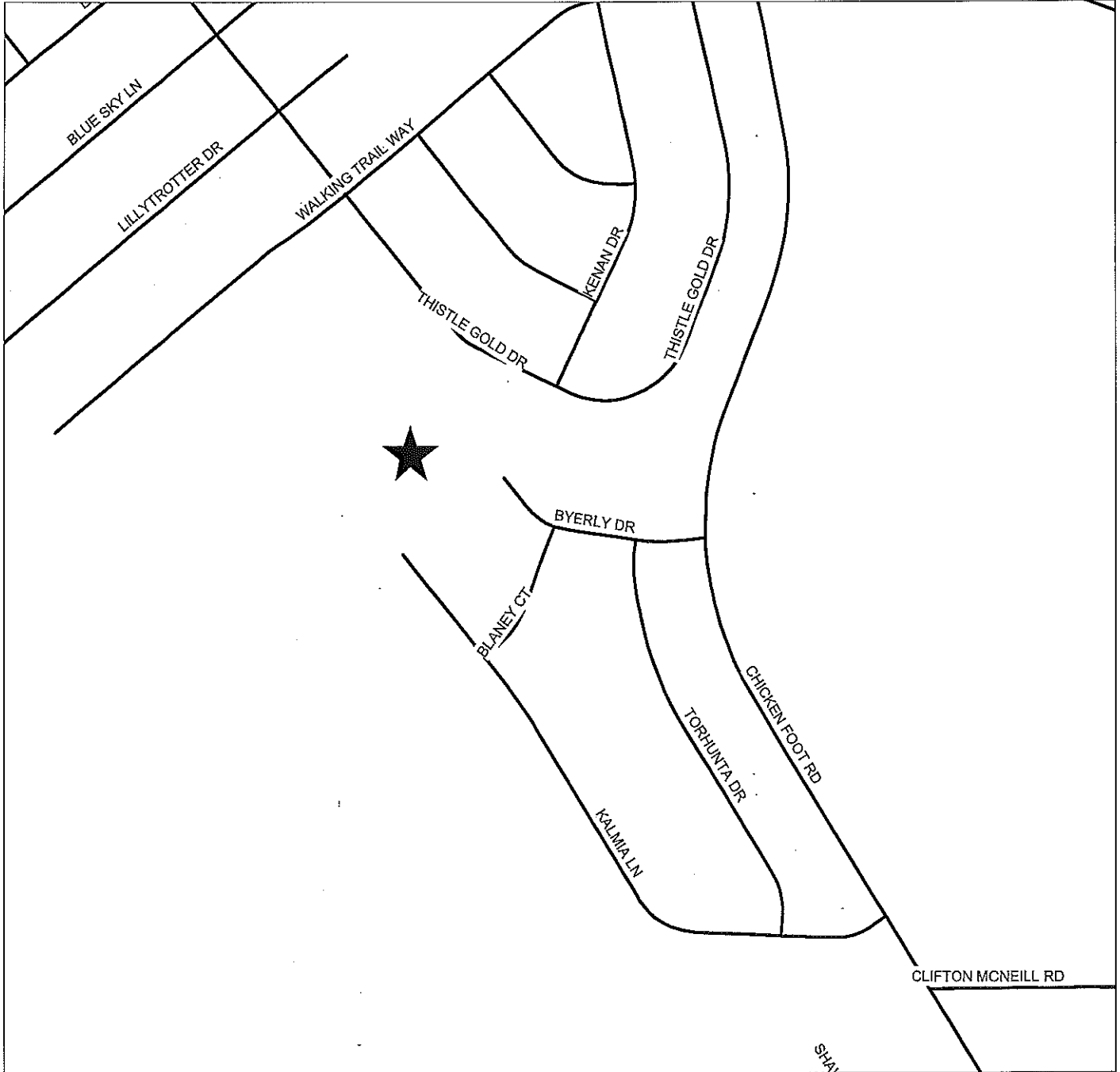

PIN(S): 0422-55-3842-
Created by GJB - EMB
JULY 5, 2017

Map not to scale



**WINCHESTER SUBDIVISION PROPERTY
ZERO LOT LINE SUBDIVISION REVIEW
CASE NO. 17-029**

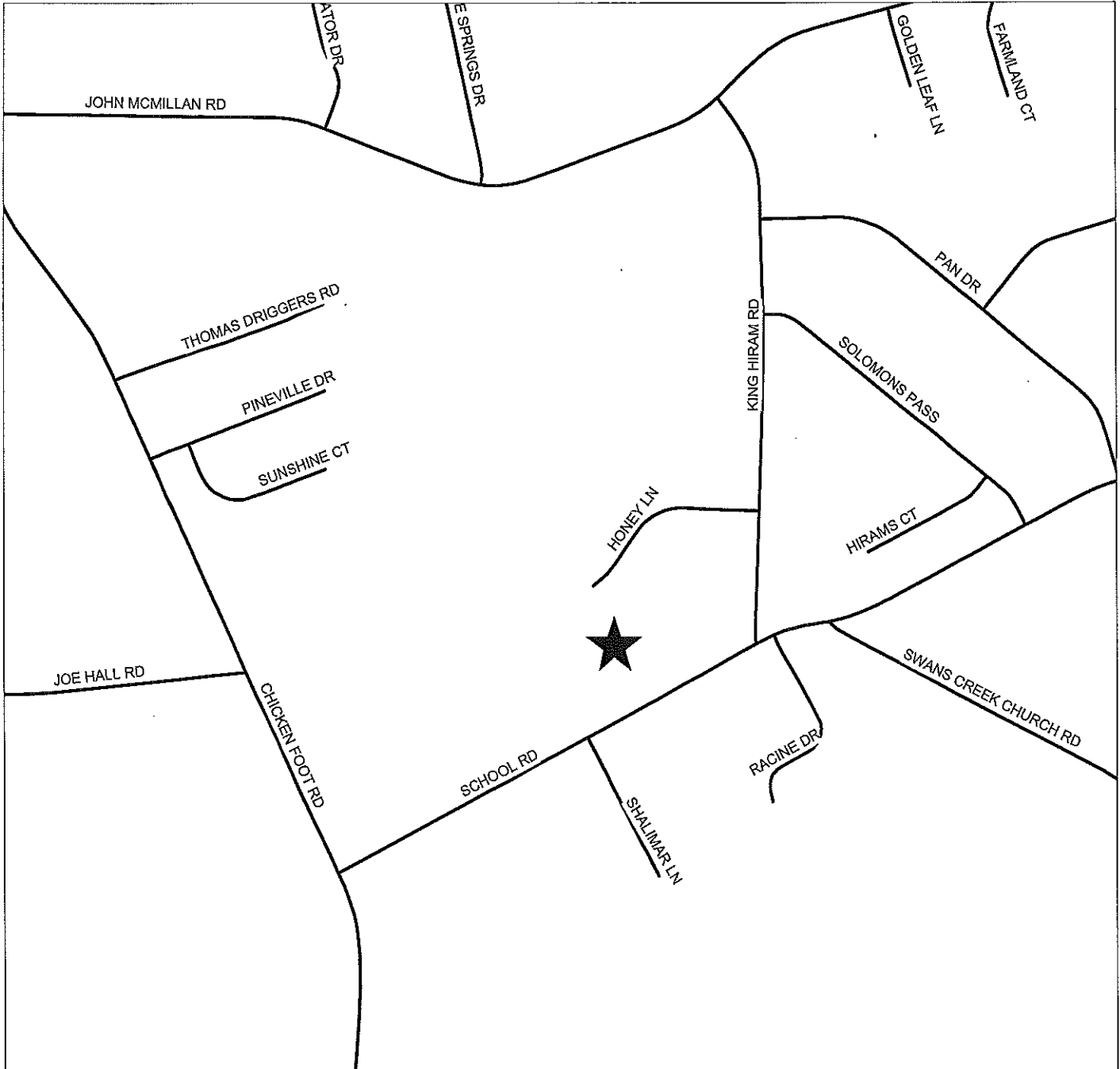

PIN(S): -0431-34-4551-
Created by GJB - EMB
March 3, 2017

Map not to scale



**ABC STORAGE
SUBDIVISION/SITE PLAN REVIEW
CASE NO. 17-055**



PIN(S): -0468-49-9836-
Created by GJB - EMB
APRIL 20, 2017

Map not to scale



**MITCHELL GILMORE PROPERTY
GROUP DEVELOPMENT REVIEW
CASE NO. 17-087**



PIN(S): 0413-95-6586-
Created by GJB - EMB
JULY 5, 2017

Map not to scale



**GARY ROBINSON HOMES PROPERTY
SUBDIVISION REVIEW
CASE NO. 17-088**

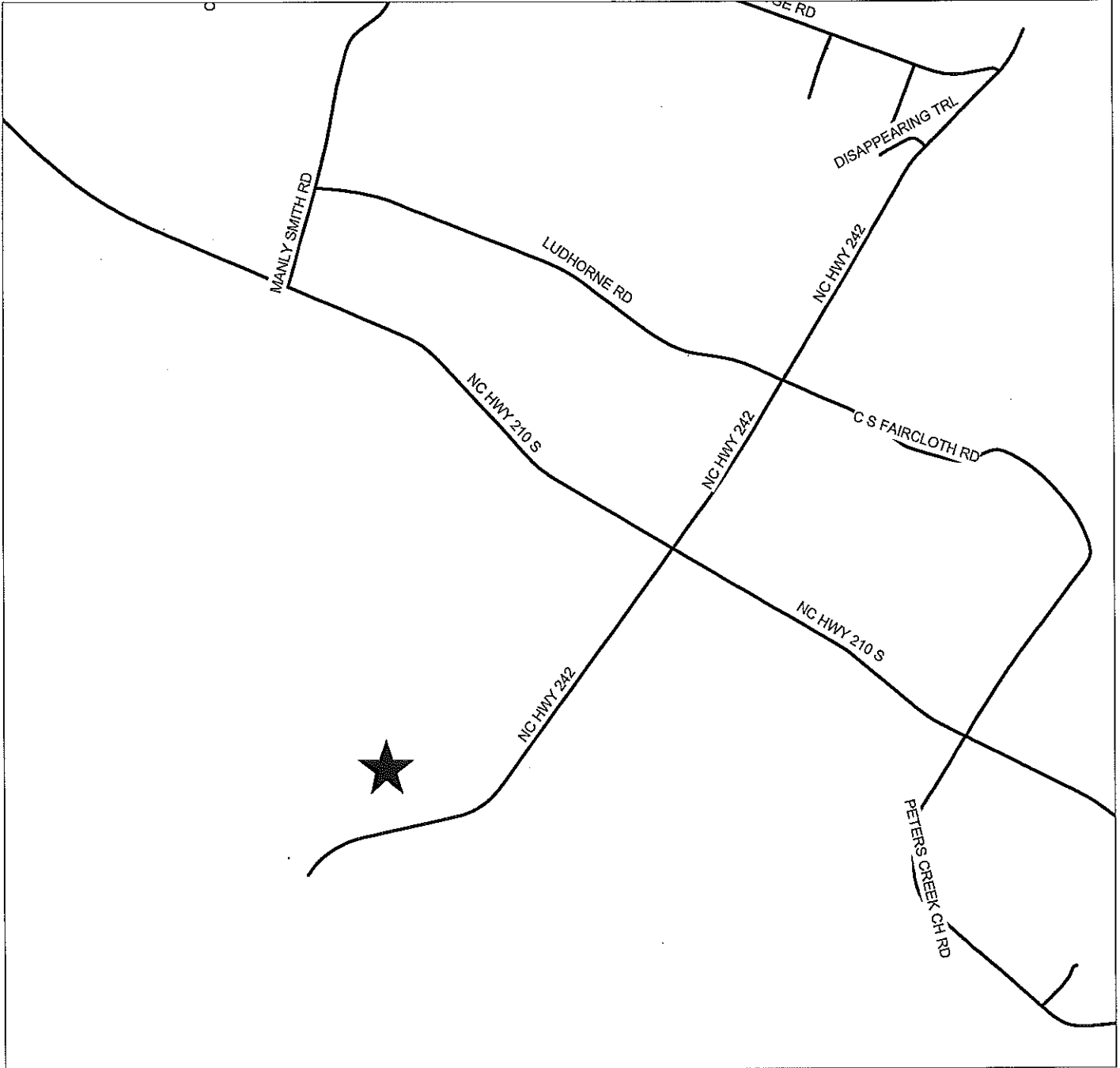

PIN(S): 1430-31-5921-
Created by GJB - EMB
JULY 7, 2017

Map not to scale



**DAVID NAIL JR. PROPERTY
GROUP DEVELOPMENT REVIEW
CASE NO. 17-093**

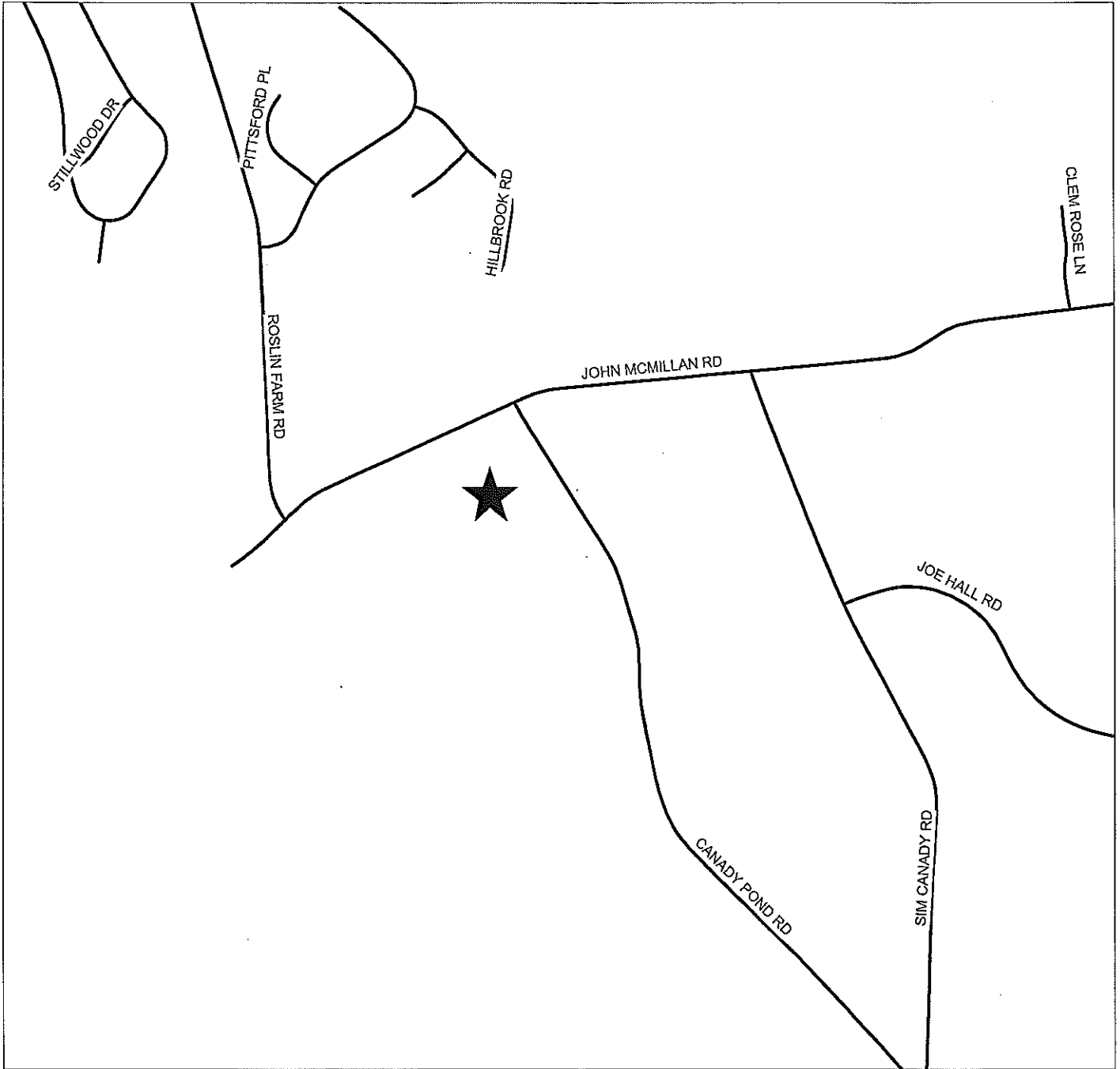

PIN(S): 0421-16-6216-
Created by GJB - EMB
JULY 14, 2017

Map not to scale



**LEISA WILLIAMS PROPERTY
GROUP DEVELOPMENT REVIEW
CASE NO. 17-089**

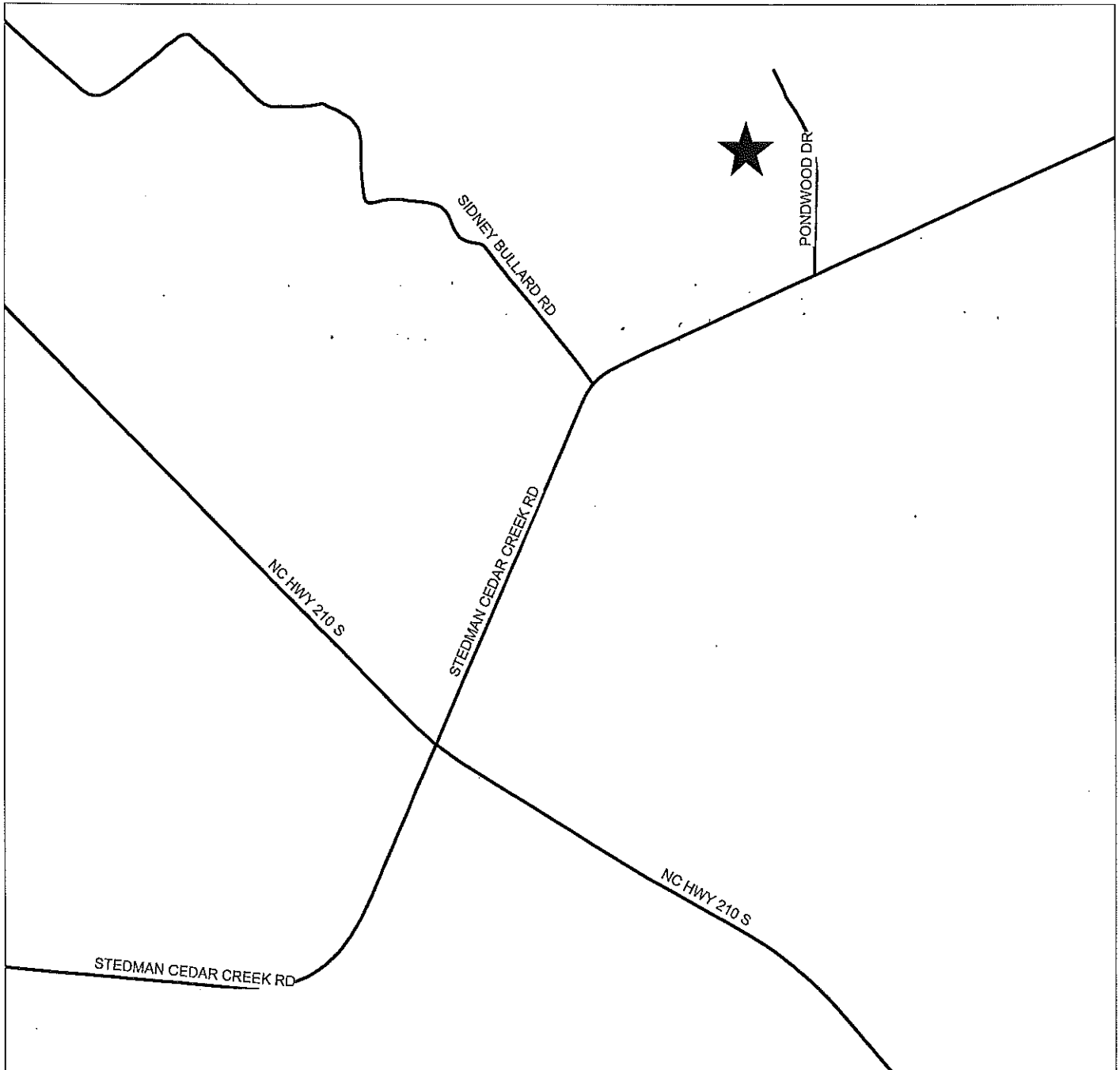

PIN(S): 0484-76-4834-
Created by GJB - EMB
JULY 10, 2017

Map not to scale



**JESSIE BRITT SR. PROPERTY
ZERO LOT LINE SUBDIVISION REVIEW
CASE NO. 17-090**

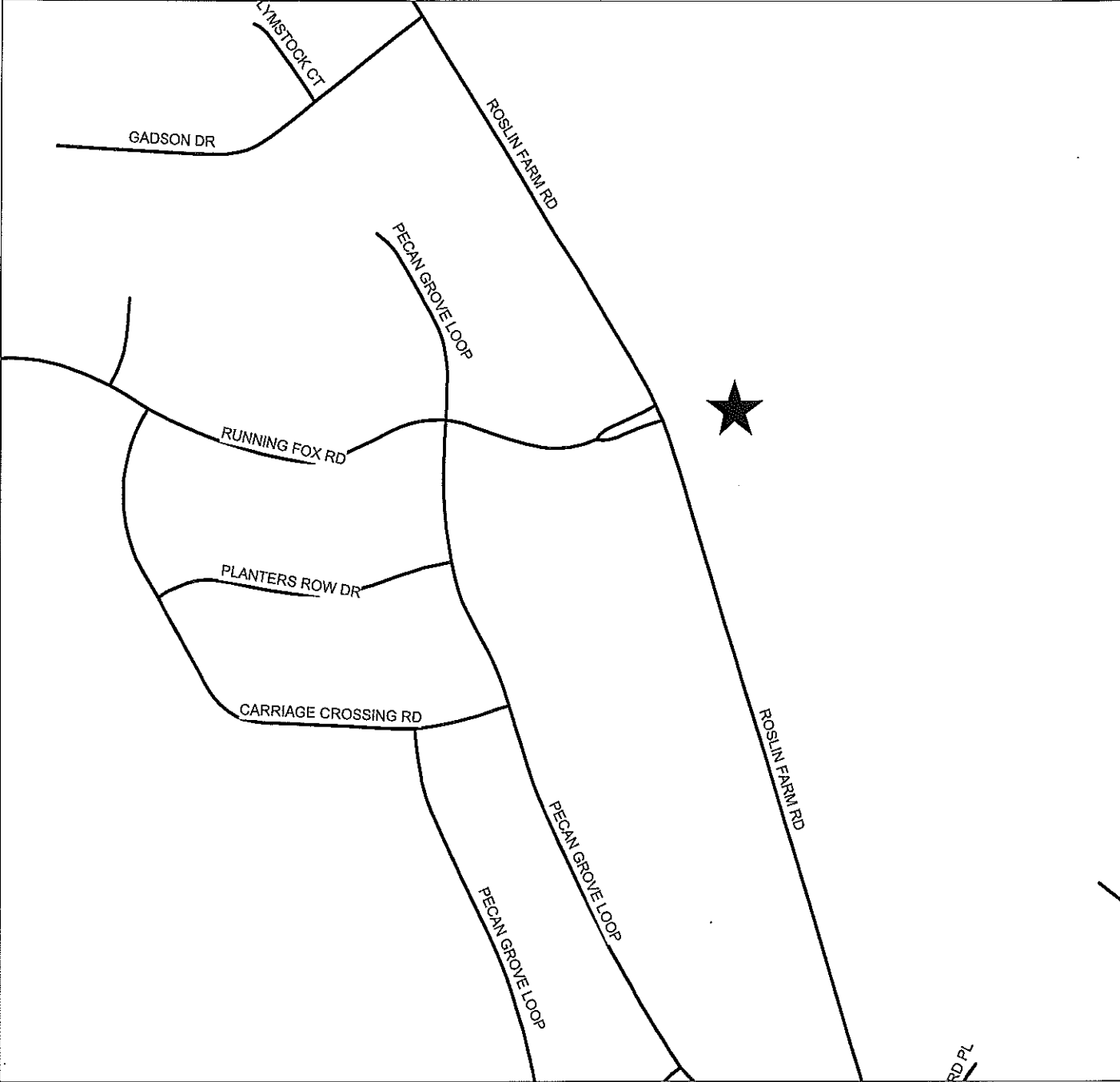

PIN(S): 0412-91-2755-
Created by GJB - EMB
JULY 12, 2017

Map not to scale

